

**BASEBALL  
TURTLES**



**828-820-8644**



**800-487-7432**

*BaseballTips, Inc.*

*Suppliers of Sports Equipment & Hydration Products - Since 1999*



**828-820-8600**

# Big Bubba Turtle



# BASEBALL TURTLES



**828-820-8644**



**800-487-7432**

BaseballTips, Inc.

Suppliers of Sports Equipment & Hydration Products - Since 1999



**828-820-8600**

ITEM	DESCRIPTION	QTY	PART #
A	FRONT CANOPY ARCHED TUBE	2 EA	ZBSARCH (2 REQUIRED)
B	MIDDLE CANOPY ARCHED TUBE	2 EA	
C	REAR CANOPY ARCHED TUBE	2 EA	
D	TOP FRAME ARCHED TUBE	2 EA	
E	BOTTOM FRAME ARCHED TUBE	2 EA	
F	FRONT BOTTOM 'L' TUBE	1 SET (2)	ZBFRNTL
G	XBARS - 86"	1 SET (5)	ZBCROSS
H	LONG ANGLE BRACE - 34"	2 EA	ZBSTUBE
I	SHORT ANGLE BRACE - 13 3/8"	2 EA	
J	STRAIGHT FRAME TUBES - 57"	4 EA	
K	COACH OBSERVATION BAR	1 EA	
L	U-LOCK CONNECTOR TUBES - 98 3/4"	6 EA	ZX0210004
M	NET & TWINE	1 EA	BIGBUBBANTDS
N	SKIRT	1 EA	BSBSK
O	RICOCHET PADDING - 72"	7 EA	ZX1700005
P	BACKSTOP DOLLEY	1 EA	ZBSDOLLEY
R	CONNECTOR STORAGE TUBES	2 EA	ZXS0100005
1	ALUM. WHEEL PLATE - 5 HOLES	4 EA	ZX0900049
2	ALUM. CANOPY PIVOT PLATE - 4 HOLES	4 EA	ZX0900050
3	POLY TWINE - 500'	1 RL	1236750
4	SHAFT COLLAR 5/8"	4 EA	Z037062COL
5	WHEEL AXLE - 5/8" X 7 1/2" CARRIAGE BOLT	2 EA	ZX3200036
6	3/8" X 3" CARRIAGE BOLT	16 EA	ZX3200035
7	3/8" LOCKNUT	16 EA	Z060375-16
8	5/8" LOCKNUT	2 EA	Z060625NLN
9	ALUM. LOCK RING	12 EA	ZX1450009
10	'T' - FITTING	24 EA	ZX1450002
11	HEX KEY .187	1 EA	Z031187HEX
12	HEX KEY .156	1 EA	Z031156HEX
13	HEX KEY 5 MM	1 EA	ZX3800005
14	TIE WRAPS - 11"	100 EA	ZX3900011
15	PLASTIC TUBE CAP	2 EA	ZX1500007
16	3/8" FLAT WASHER	32 EA	Z070037Z/P
DG	16" WHEEL	3 EA	ZX2800006

ZBBHDWPK

ZBSWHEEL

## STEP 1

— ASSEMBLY REQUIRES - 2 ADULTS, LADDER, SOCKET WRENCHES, HAMMER, ADJ. WRENCH —

NOTE: DISCARD THE 20 PCS OF 4" TUBE  THEY ARE FOR SHIPPING PURPOSE ONLY.

- Assemble your Batting Cage in a large area where it is to be used. Layout the following items as shown in diagram - 2 each (E), - 1 each (G), - 2 each (I), - 2 each (H), - 4 each (J), - 4 each (#1).
- Slide 3 each T-fittings (#10) over both Arched tubes (E) and 2 each T-fittings (#10) over item (G). Note: All T-fittings should be put on with the screws facing the outside of the cage.
- Slide 1 each Locking Ring (#9) over both Arched tubes (E).
- Insert both ends of (G) into (E) line up screw in Locking Collar (#9) with the hole and tighten screw. See Detail.
- Attach 4 each Wheel Plates (#1) as shown using Carriage Bolts (#6), Lock Nuts (#7) and Washers (#16). Do not tighten at this time.

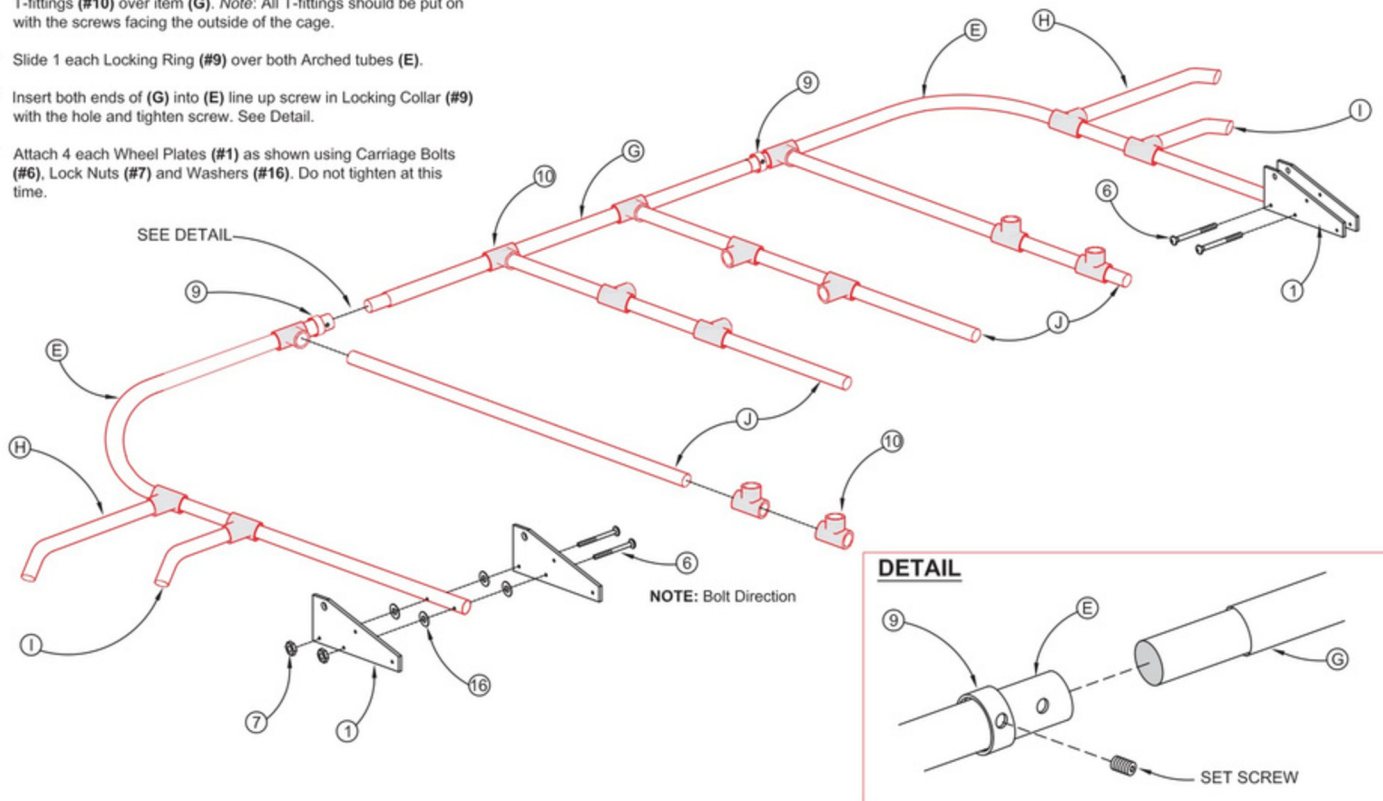

## STEP 2

- Layout 2 each Arched tubes (D) and slide 3 each T-fittings (#10) and 1 each Locking Collar (#9) over both.
- Slide 2 each T-fittings (#10) over item (G). Insert both ends of (G) into (D) line up Locking Collar (#9) with hole and tighten screw.

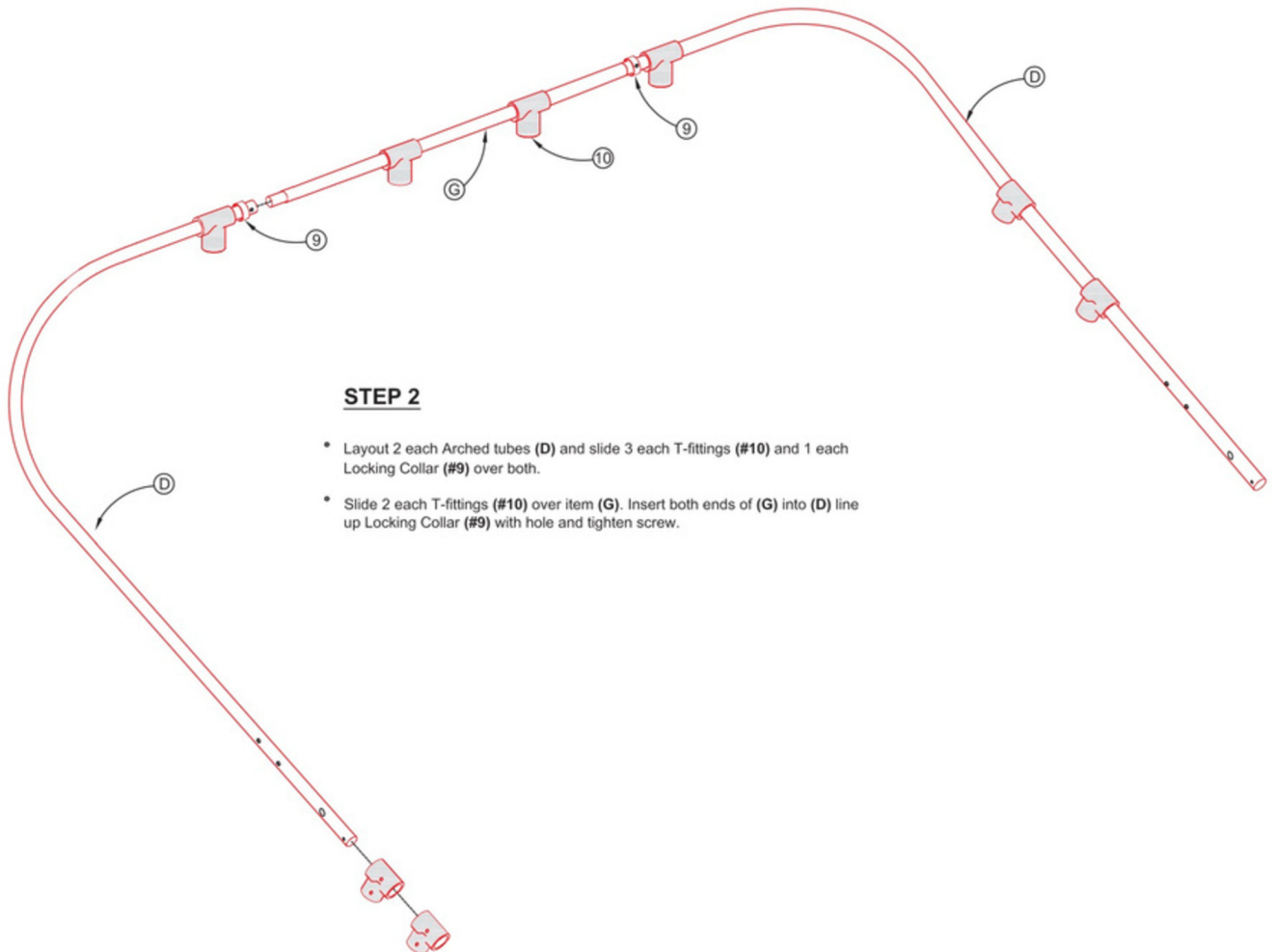

### STEP 3

- Stack the 2 U-shaped assemblies as shown in diagram and attach both items (D) to the Wheel Plates (#1) using Carriage Bolts (#6), Lock Nuts (#7), and Washers (#16). Do not tighten at this time.
- Raise the upper U-shaped assembly and hold in place with the 4 each 57" straight tubes (J). Do not tighten the set screws in T-fittings at this time.
- Attach both Wheels (DG) using Carriage Bolts (#5), Shaft collars (#4), Lock Nuts (#8). One Shaft Collar holds the Carriage Bolt in place and the other Shaft Collar spaces the Wheel so it doesn't rub on the frame.
- Position both the 18" Angle Braces (I) with the upper T-fittings and position both the 34" Angle Braces (H) with the upper T-fittings. Hold Frame square and tighten these 8 T-fittings at this time.

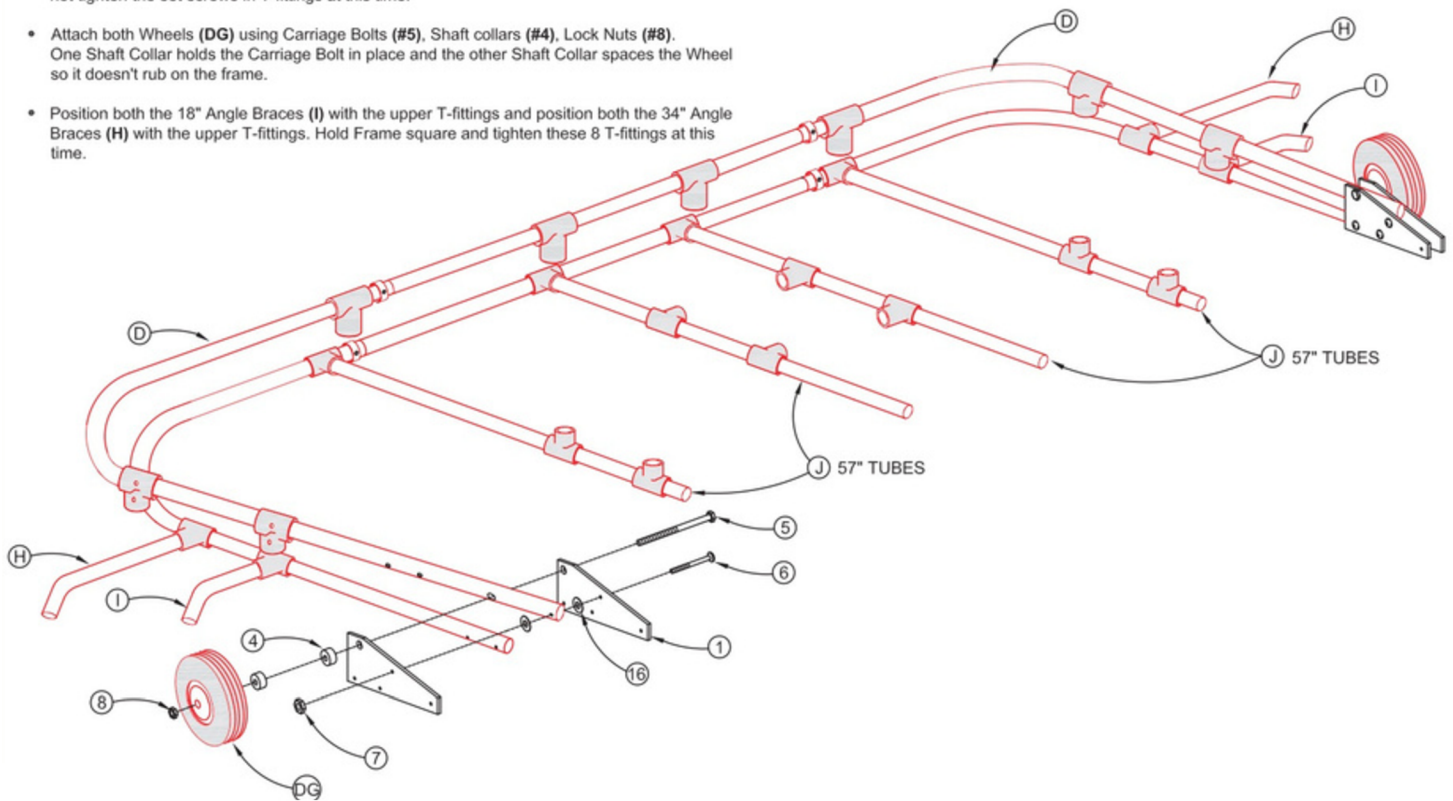

### STEP 4

- Locate the Coaches Observation Bar (K), and place it in the T-fittings as shown. Slide it all the way to the top and tighten set screws. Position Observation Bar in the center of Cage and tighten those T-fittings at this time.
- Attach the Storage Tubes (R) as shown and tighten at this time.
- Locate the Front L tubes (F) and attach them using Carriage Bolt (#6), Washer (#16) and Locking Nut (#7) as shown. All Bolts and Nuts on Wheel Plates (#1) can be tightened at this time. Do not over tighten Bolt for Front L tube.

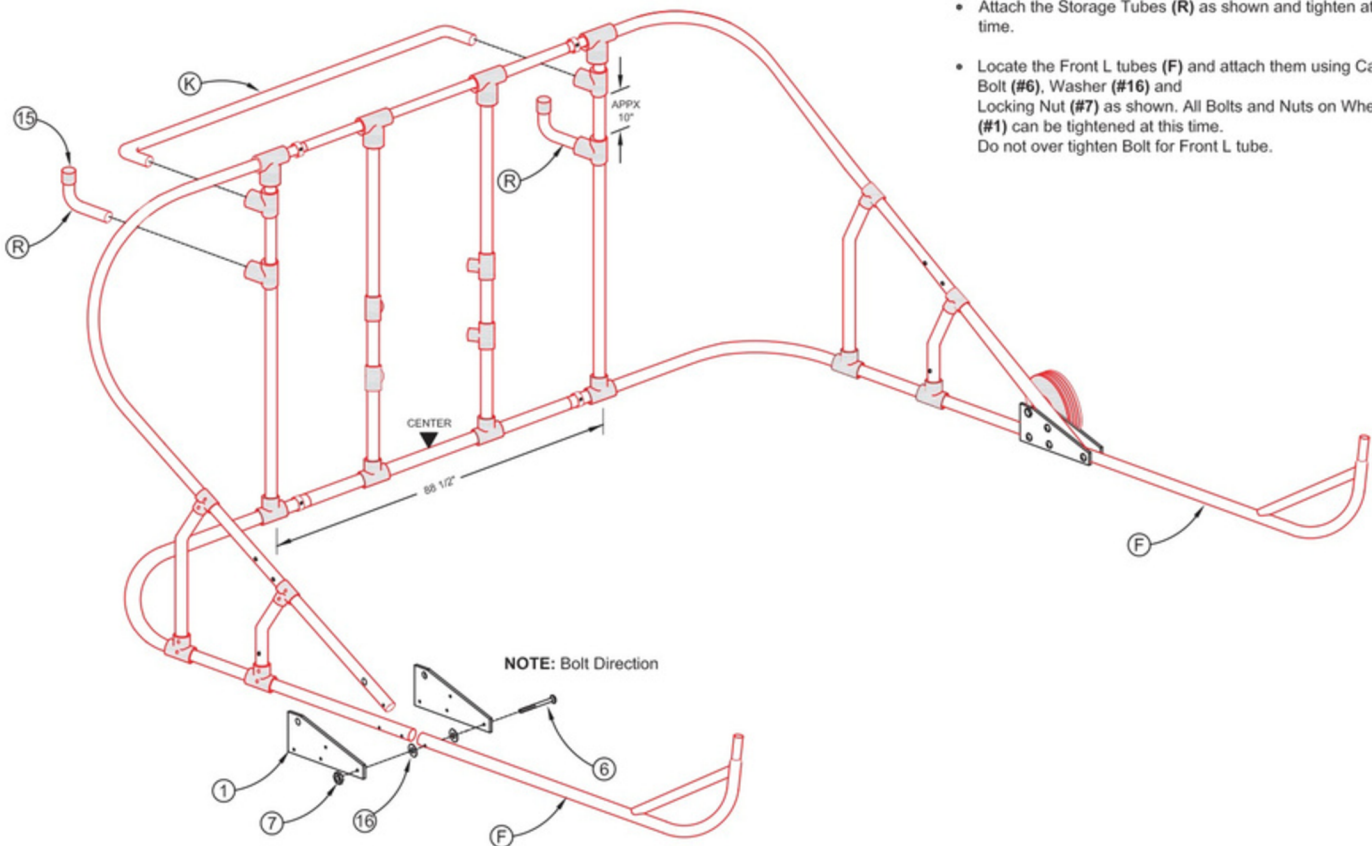

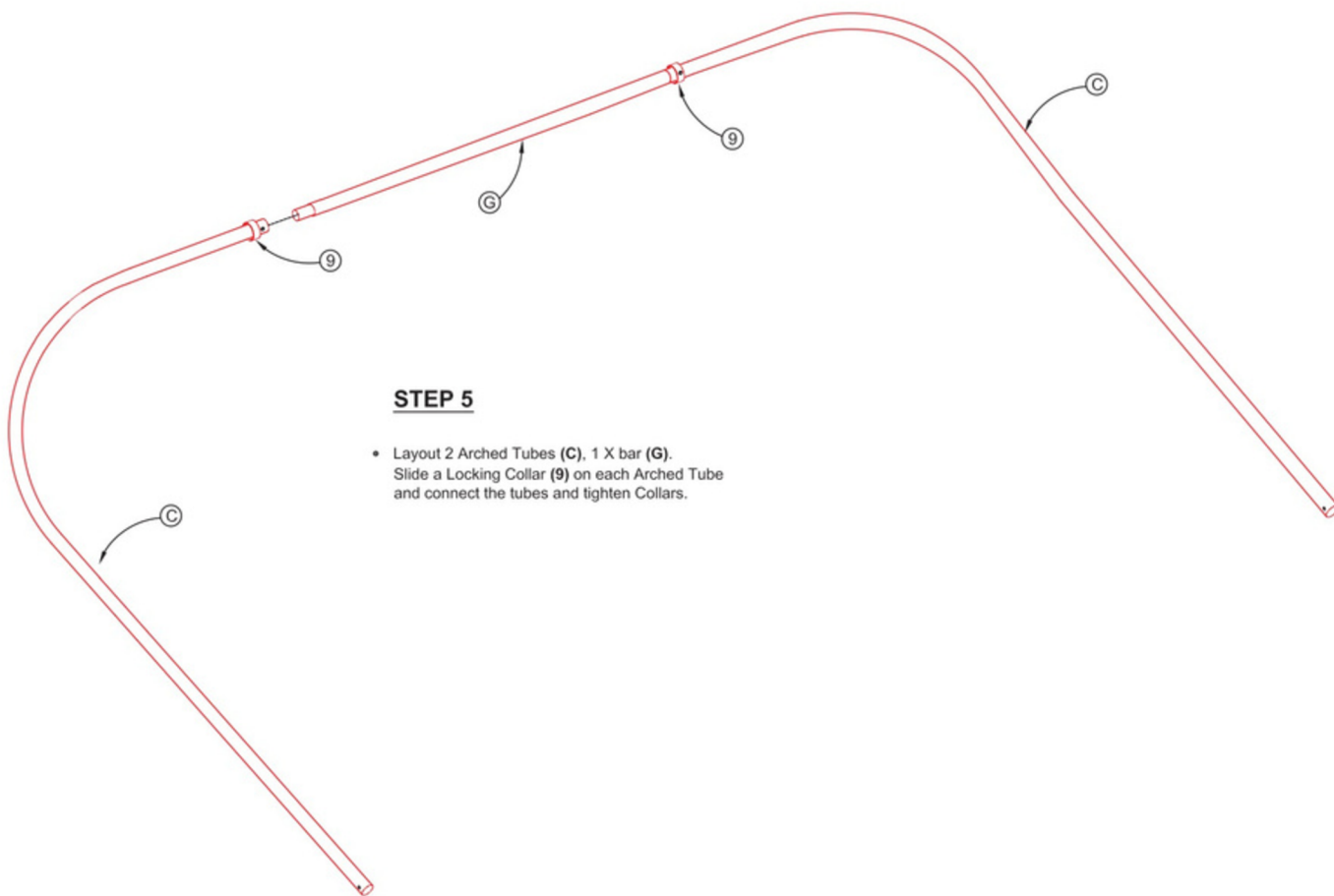

### STEP 5

- Layout 2 Arched Tubes (C), 1 X bar (G). Slide a Locking Collar (9) on each Arched Tube and connect the tubes and tighten Collars.

### STEP 6

- Locate and attach 4 Canopy Pivot Plates (#2) to Frame (D) using Carriage Bolts (#6), Washers (#16) and Locking Nuts (#7). Do not tighten at this time.
- Stack the previously built U-shape assembly (C) on Frame (D) as shown and attach to Plate (#2) using Carriage Bolts (#6), Washers (#16) and Locking Nuts (#7). Do not tighten at this time.

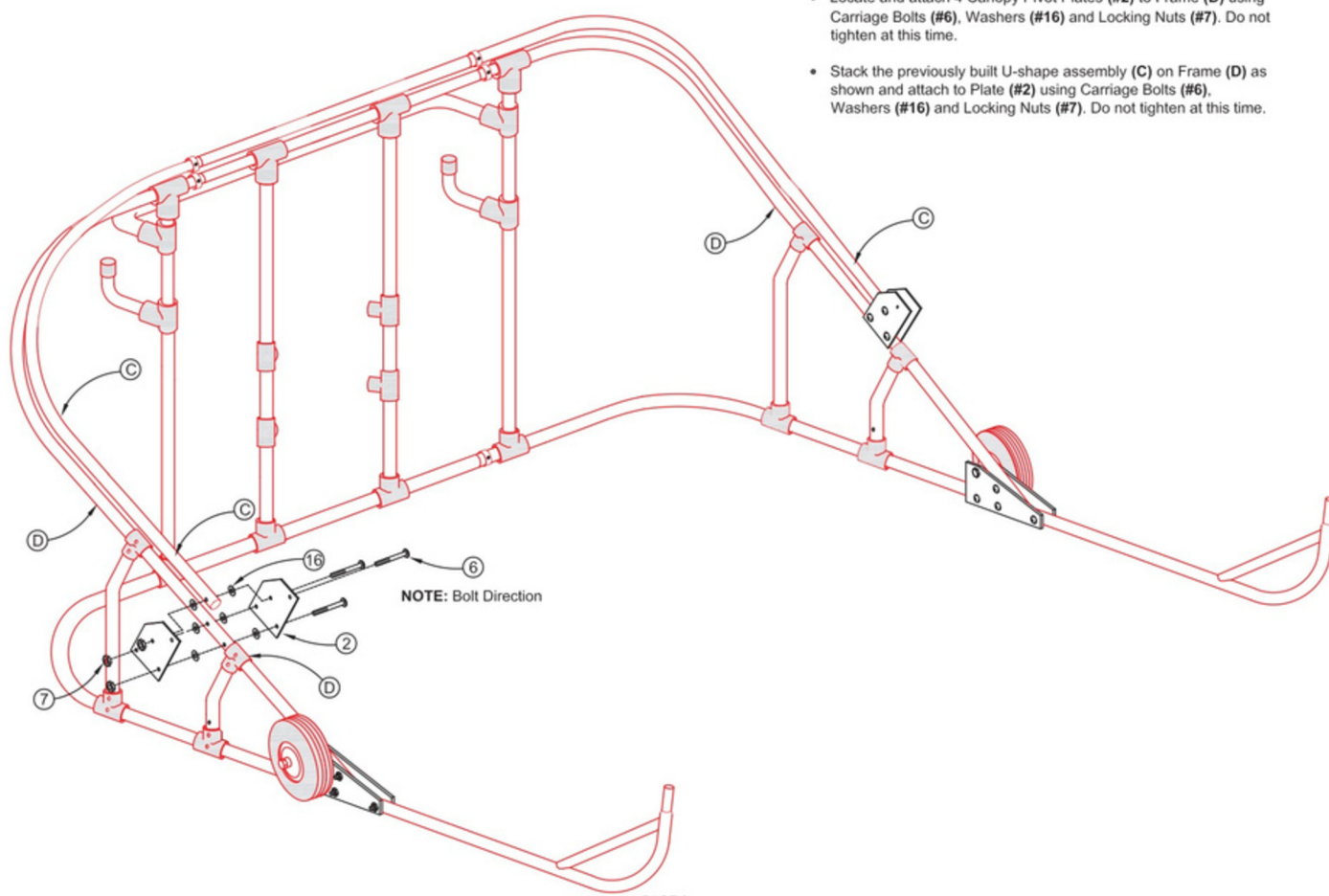

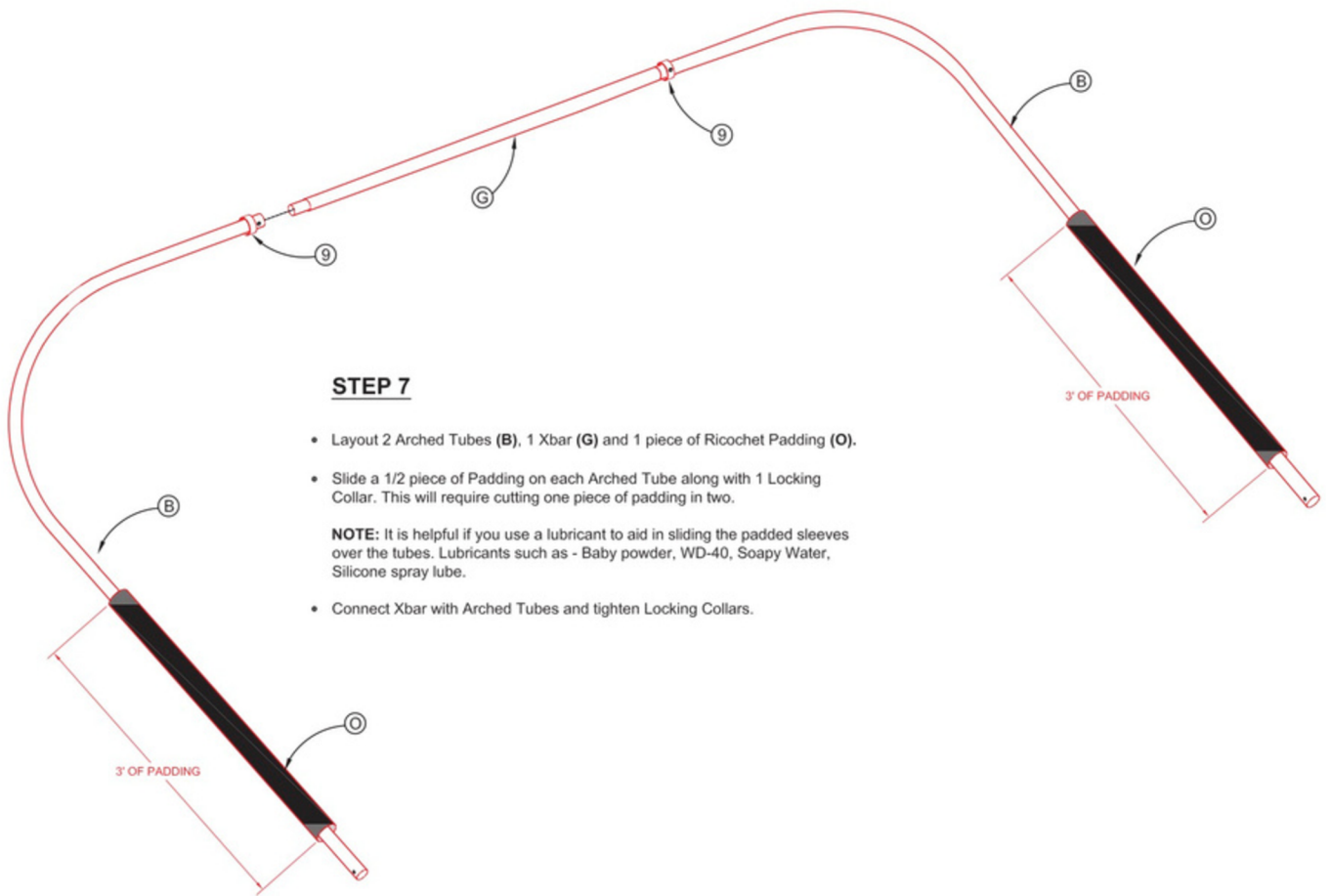

### STEP 7

- Layout 2 Arched Tubes (B), 1 Xbar (G) and 1 piece of Ricochet Padding (O).
  - Slide a 1/2 piece of Padding on each Arched Tube along with 1 Locking Collar. This will require cutting one piece of padding in two.
- NOTE:** It is helpful if you use a lubricant to aid in sliding the padded sleeves over the tubes. Lubricants such as - Baby powder, WD-40, Soapy Water, Silicone spray lube.
- Connect Xbar with Arched Tubes and tighten Locking Collars.

### STEP 8

- Stack the previously built U-shape assembly (B) on the Frame as shown and attach to Plate (#2) using Carriage Bolts (#6), Washers (#16) and Locking Nuts (#7).
- You can tighten all Bolts in this Plate (#2) at this time; please do not over tighten; these U-shape assemblies need to hinge in this Plate.

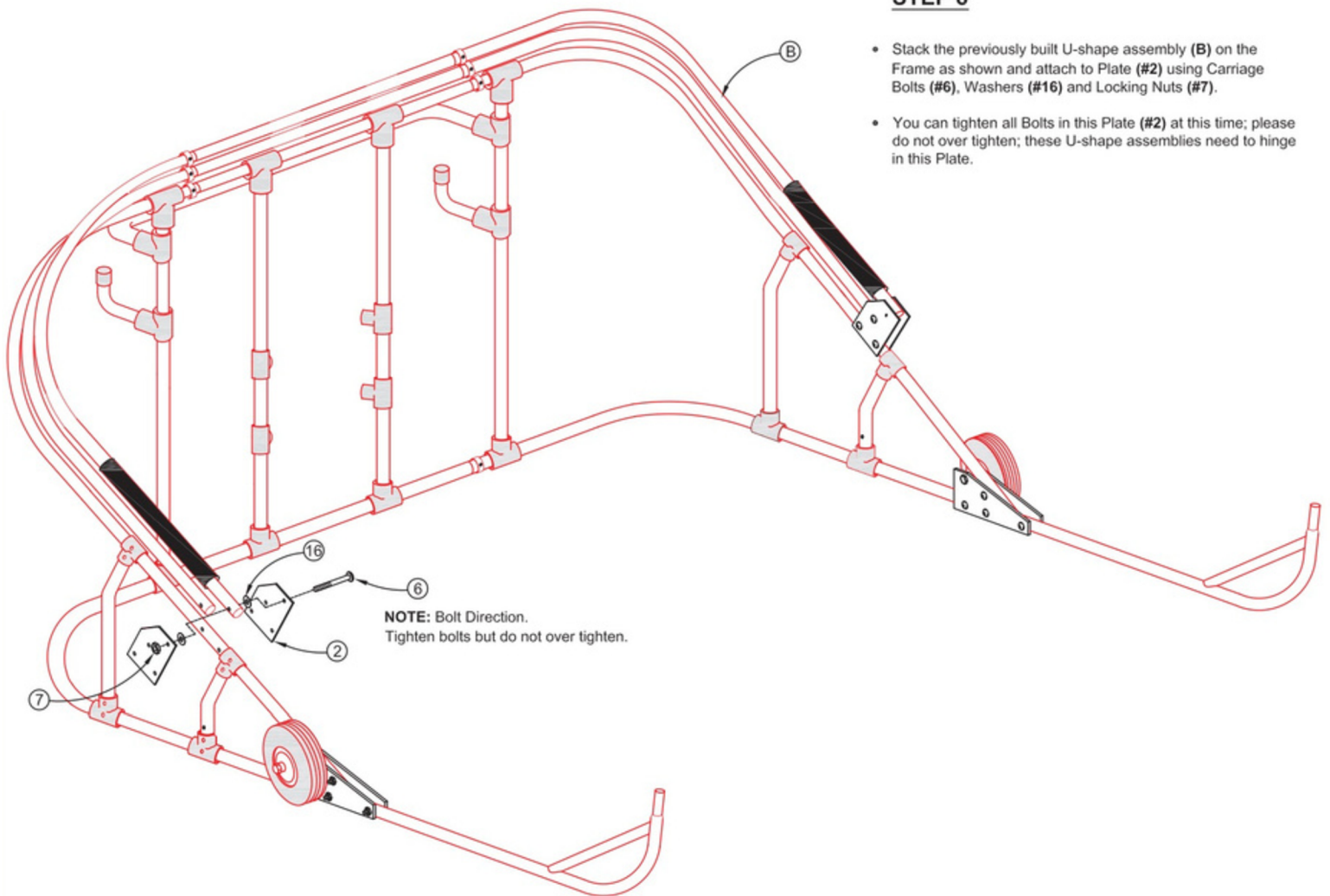

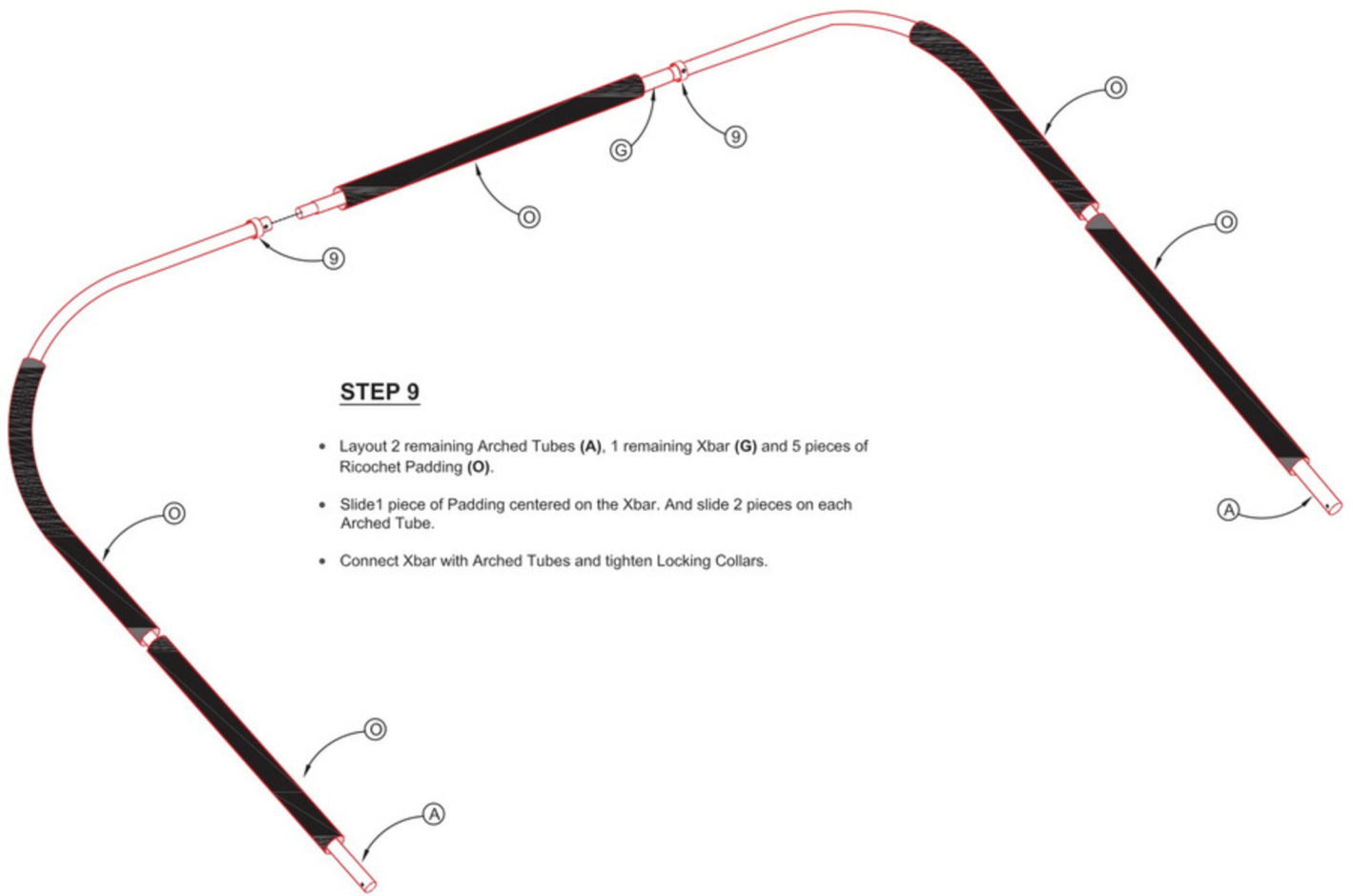

## STEP 10

- Stack the previously built U-shaped assembly (A) on the Frame as shown and attach it to the Front L-shape tubes (F) using the remaining Locking Collars.
- Locate the 2 V-tubes (DB) and 2 Crossover Fittings (DC) and attach them to the 4 T-fittings on the back of the Main Frame. This will position the two 57" Straight Tubes so you can now tighten the 4 T-fittings holding them.
- Check and securely tighten all set screws, nuts and bolts at this time.

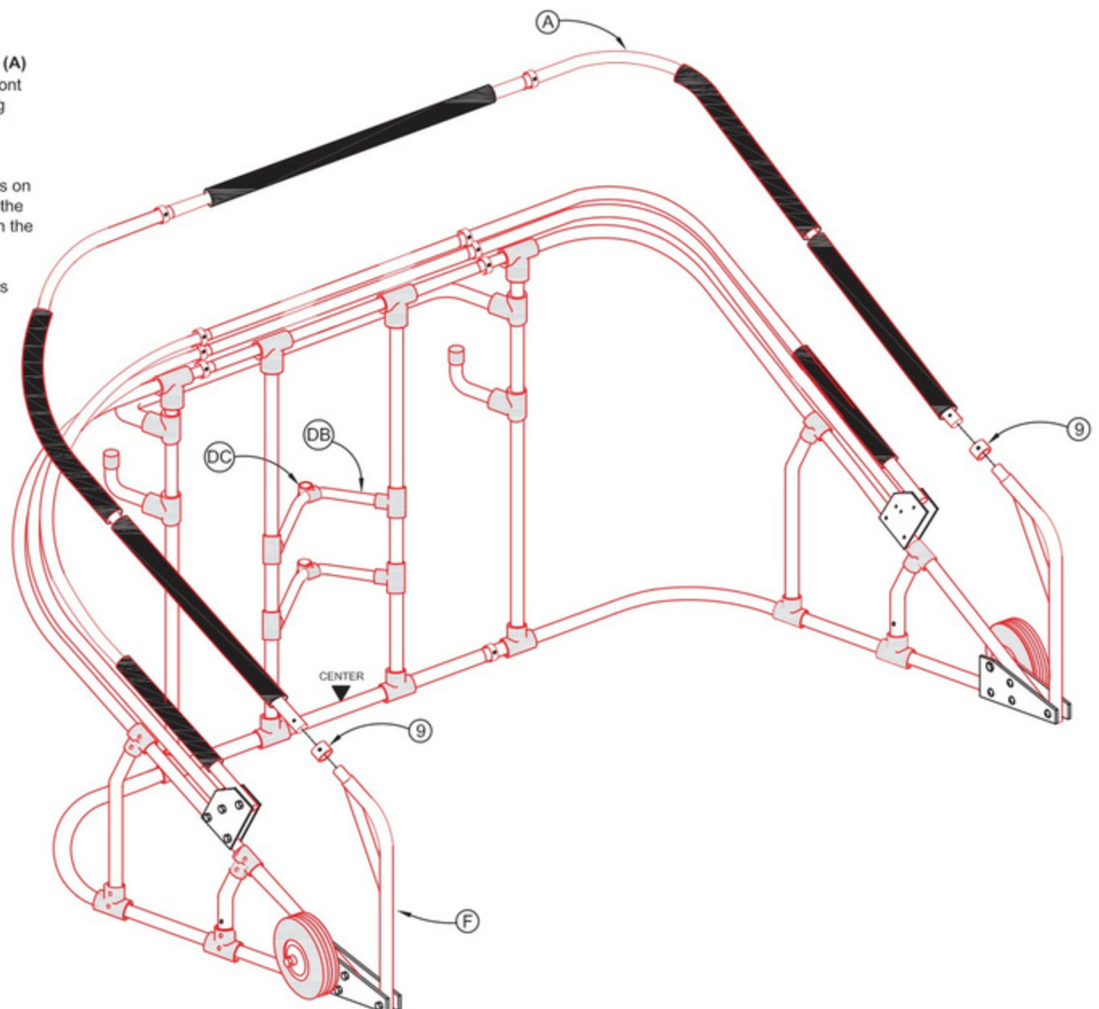

## STEP 11

- With the assembled Frame in the collapsed position, spread out the Net (**M**) inside the Frame.  
**NOTE:** The net has a tag attached to it on the "top-front-center-position".
- Using Tie Wraps (**#14**) temporarily attach the Net (at the tag) to the center of the Front Canopy (**A**). Working your way out from there in both directions, attach the Net to the Front Canopy every 3 feet till you reach the ground. Verify the Net is centered on the frame.
- Locate 2 U-Lock Connectors (**L**) and raise Front Canopy by attaching one end of the U-Lock Connectors to the Front Canopy and the other end of the U-Lock Connectors to Canopy (**B**) as shown in Detail A and View 1.

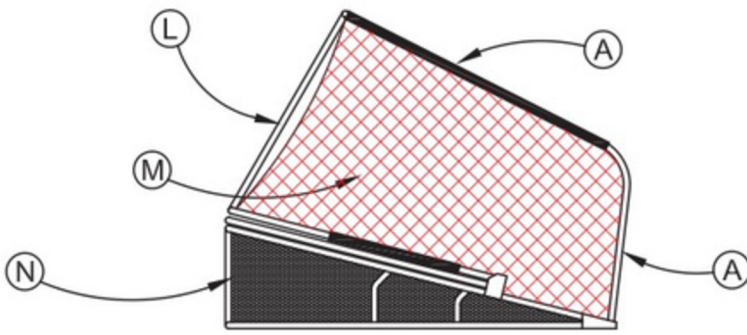

VIEW 1

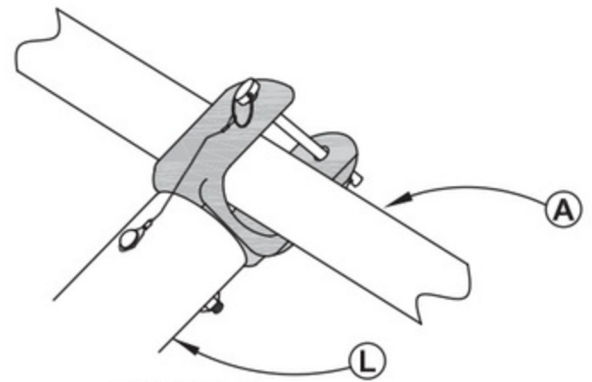

DETAIL A

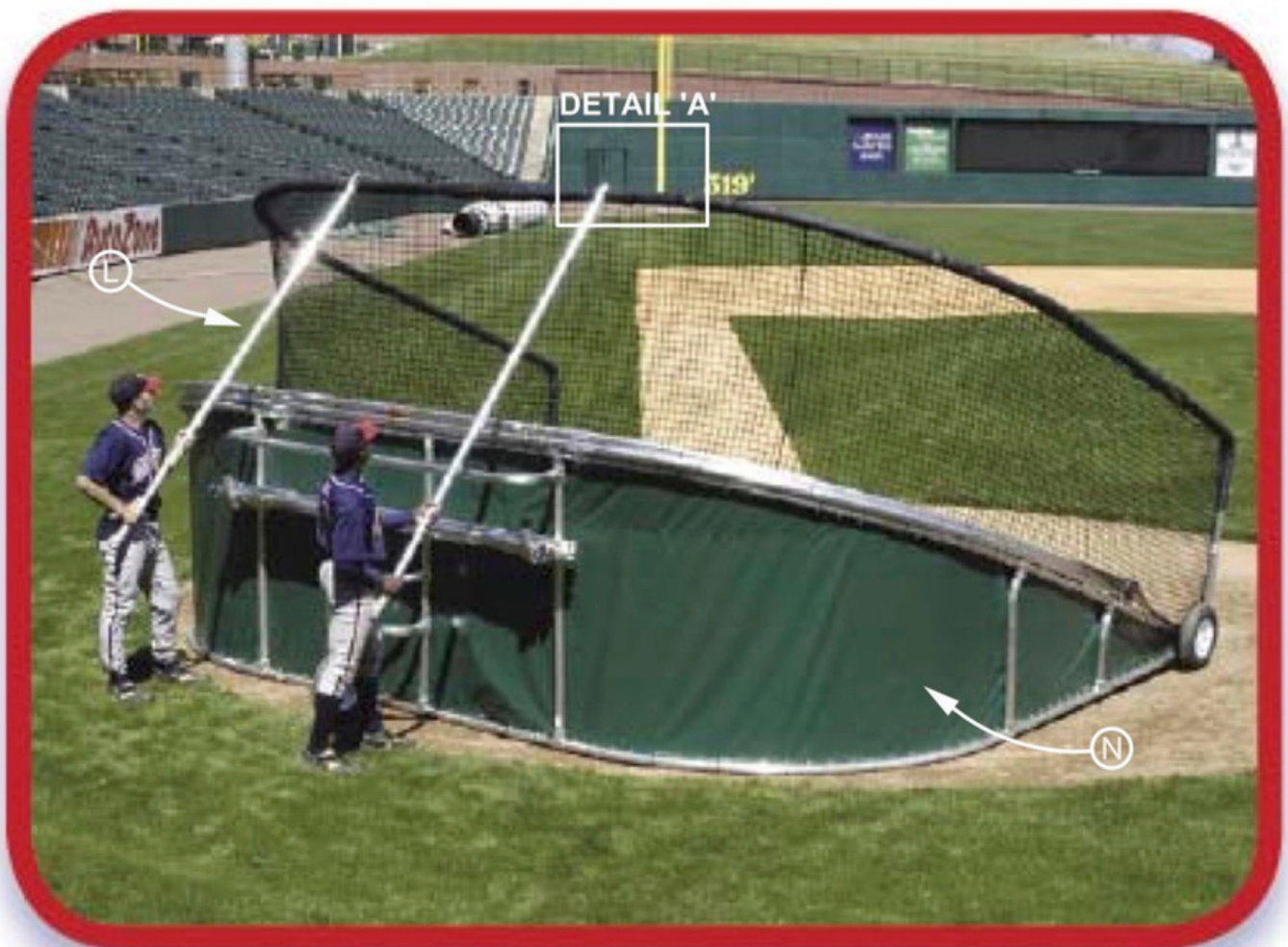

## STEP 12

- Using the Poly Twine supplied make 3 - 6" drop twines as shown in Detail below and attach the center of the Net and the two heavy rope seams of the Net to Canopy (B).
- **NOTE:** The net fits very tight when first attached so it is a ***must that you stretch it as much as possible*** when attaching from one canopy to the next otherwise the net will seem to be short at the end. Then net will stretch in time and have a looser fit.
- Take 2 more U-Lock Connectors and raise Canopy (B) and attach U-Lock Connectors to Canopy (C) as shown in View 2.

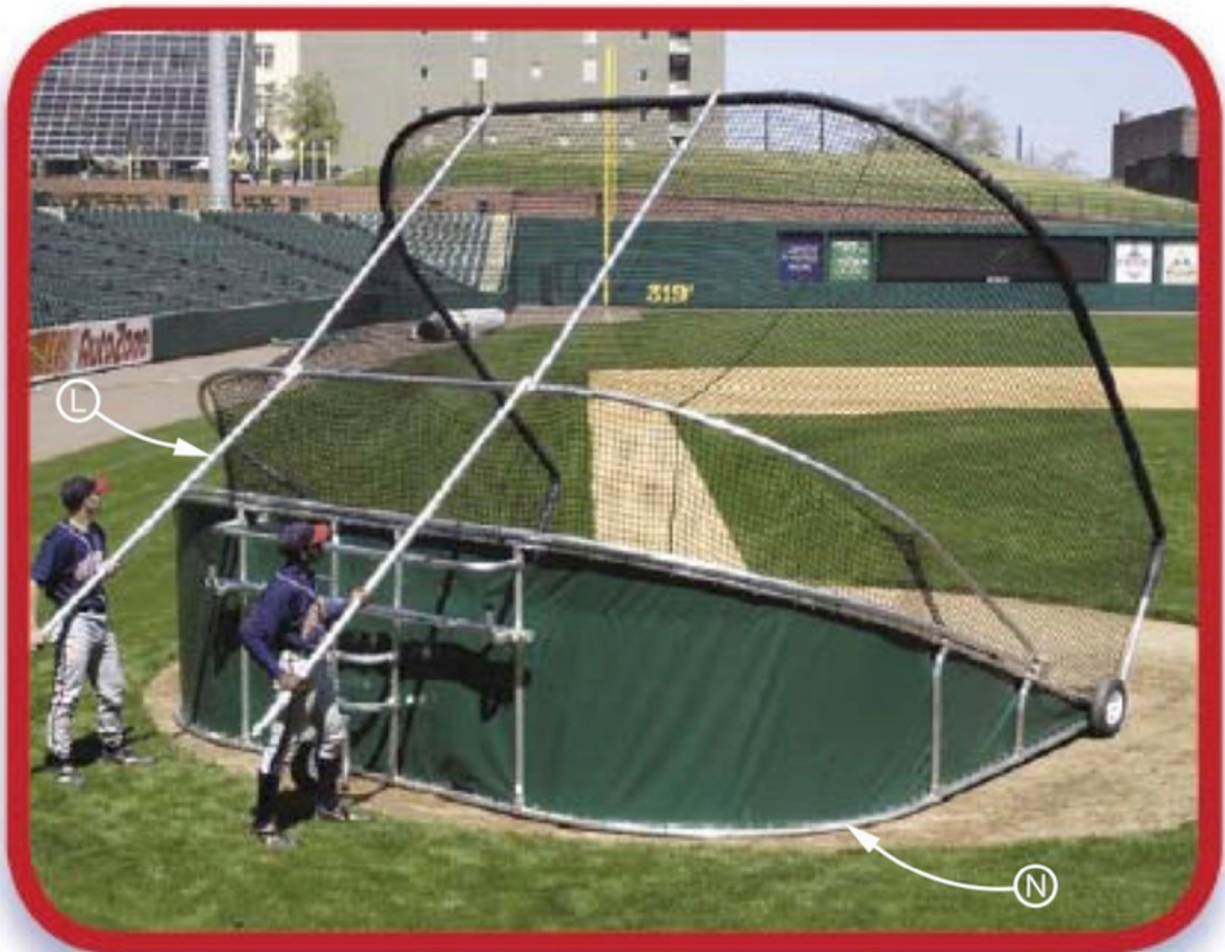
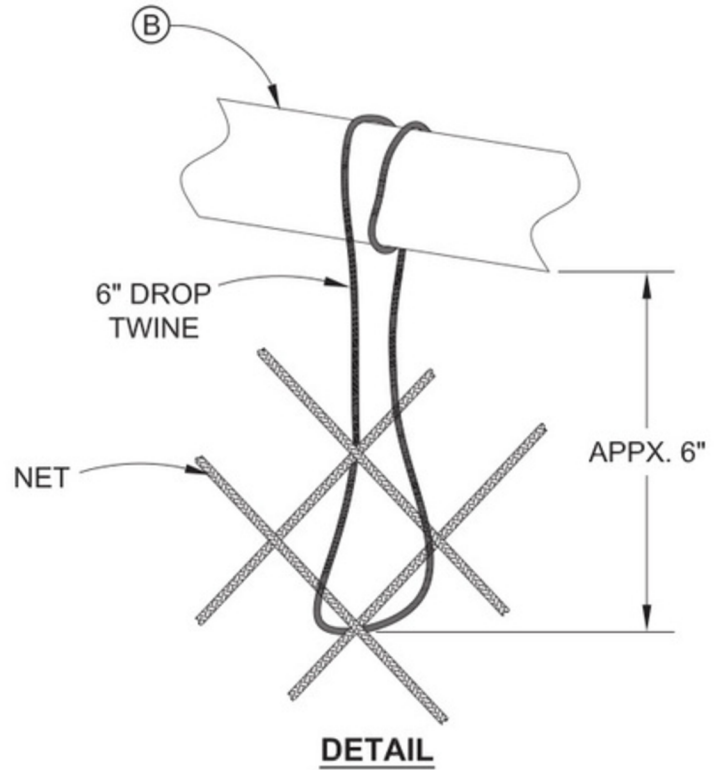
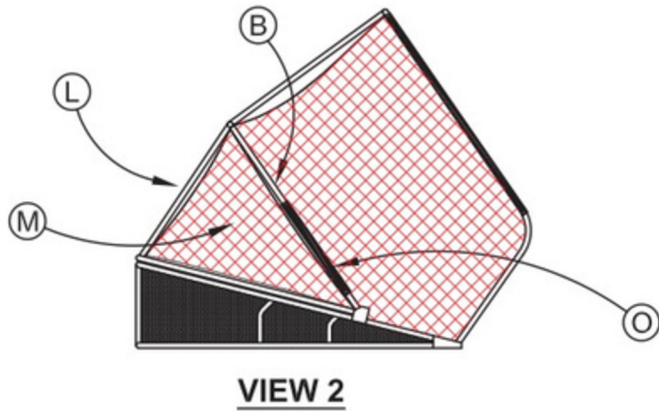

## STEP 13

- Using the Poly Twine supplied make 3 - 6" drop twines and attach the center of the Net and the two heavy rope seams of the Net to Canopy (C).
- Take the remaining 2 U-Lock Connectors and raise Canopy (C) and attach U-Lock Connectors to Top Frame (D) as shown in View 3. The Cage is now at its fully extended position.
- Using Tie Wraps temporarily attach the bottom boarder of the Net to the Top Frame (D) every 3 feet all the way around to the Wheel Plates on each side. Verify the Net is centered on Frame.

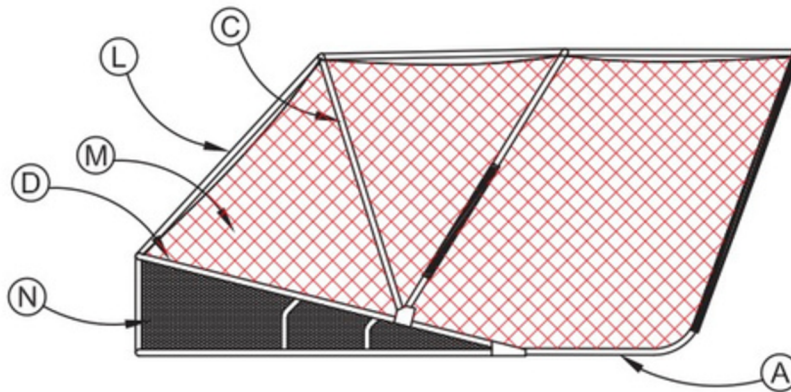

**VIEW 3**



## STEP 14

- Using Tie Wraps temporarily attach the top of the Skirt (**N**) (top is the tapered side) to the Top of Frame (**D**) every 3 feet all the way around to the Wheel Plates on each side. Verify the Skirt is centered.
- Now using the Poly Twine begin permanently lacing the Net and Skirt to the Top Frame (**D**) from Wheel to Wheel.
- Follow the same procedure to permanently lace the bottom of the Skirt to the Bottom of Frame.
- Now using the Poly Twine (**#3**) begin permanently lacing the Net to the Front Canopy (**A**) starting just in front of the Wheel Plate on one side and finishing at the Wheel Plate on the opposite side.
- Use 6" drop twines to attach Net to Canopy (**C**) approximately 9 places and Canopy (**B**) approximately 9 places.
- Use Tie Wraps or Twine to attach the 10' x 10' Baffle Net; position behind home plate as deep as desired.
- Your Batting Cage is now fully erected. See separate Assembly Instructions for Dolly Assembly.

**WARNING** Always use 2 adults to raise, collapse or transport Cage.

**WARNING** Always collapse Cage when not in use or in High Winds.

**WARNING** Never transport Cage unless it is in the fully collapsed position.

**WARNING** Always lower transport dolly so bottom of frame is setting firmly on the ground before raising the Cage.

**WARNING** Never allow anyone to stand close to the netting while Cage is in use. This could result in serious injury.

**WARNING** Do Not Climb on Cage at any time. This could result in serious injury or damage to Cage.

**WARNING** Never use U-Lock Connectors without the Detent Pin in place.

